



Item # 20135778, INSTA-LOCK Fitting TYPE F Male Adapter x Male NPT Thread F200AL 2 in Aluminum

APPLICATION: Type F fitting is normally threaded into pipe or manifold connections and mated with Part C, Part B, or Part D. Used in applications that require frequent connections. Insta-Lock™ fittings are designed for liquids and dry bulk. Consult the chemical resistance guide for specific chemical recommendations.

BRANDING: Example: Continental Contitech F200SS

PRESSURE RATING: Sizes 1/2"– 2", 250 psi; sizes 2 1/2"– 4", 150 psi; sizes 5"– 6", 75 psi. Recommended working pressure ratings based on ambient temperature (70 °F).

Note: Continental Contitech Insta-Lock Fittings are never to be used in steam or compressed air service. Continental Contitech Insta-Lock Cam Arms are designed exclusively for Insta-Lock fittings.

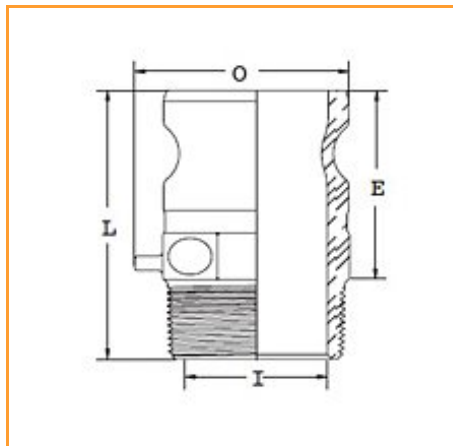

[Product Specifications](#) | [Specifications](#)

Product Specifications

Style	Type F
Material	Aluminum
Brand	INSTA-LOCK™ TYPE F

Order Code

650-830

Specifications

End Type A	Male Adapter
End Size A	1 1/4
End Type B	Hex Male NPT Thread
End Size B	1 1/4
O - Max. O.D.	2.130 in 54.10 mm
L - Overall Length	3.156 in 80.16 mm
E - Exposed Length	2.279 in
I - Min. I.D.	1.187 in
Weight	0.6800 lb
Distance Chain Lug Extends from Body	0.375 in
Order Increment	1

MideastUS@contitech.us

1-800-235-4632

Contitech.us

ContiTech